

## Tape Schematic<sup>5</sup>

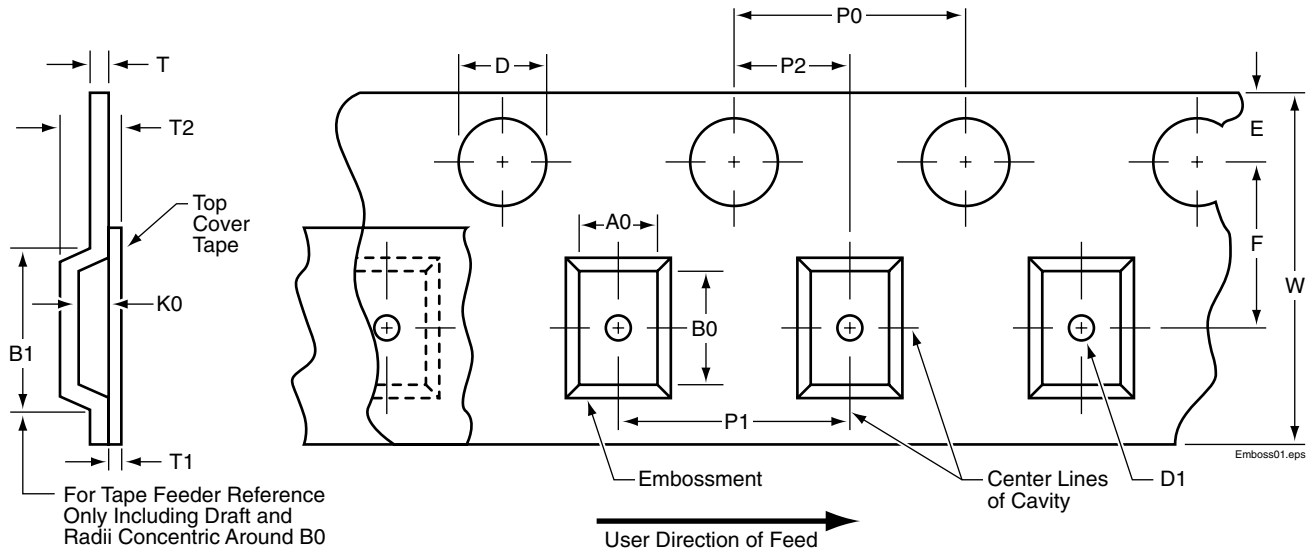

### Embossed Tape — Constant Dimensions

Tape Size	D	E	P0	P2	T Max.	T1 Max.
8mm and 12mm	$1.5^{+0.10}_{-0.0}$ ( $0.59^{+0.004}_{-0.0}$ )	$1.75 \pm 0.10$ ( $0.069 \pm 0.004$ )	$4.0 \pm 0.10$ ( $0.157 \pm 0.004$ )	$2.0 \pm 0.05$ ( $0.079 \pm 0.002$ )	0.600 (0.024)	0.10 (0.004)

ELD/B\_102.at3

### Embossed Tape — Variable Dimensions

Tape Size	A0, B0, K0	B1 See Note 4	D1 See Note 3	F	T2	P1	W
8mm 1/2 Pitch	See Note 1	4.55 (0.179)	1.0 (0.039)	$3.5 \pm 0.05$ ( $0.138 \pm 0.002$ )	2.5 Max. (0.098)	$2.0 \pm 0.10$ ( $0.079 \pm 0.004$ )	$8.0^{+0.3}_{-0.1}$ ( $0.315^{+0.012}_{-0.004}$ )
8mm						$4.0 \pm 0.10$ ( $0.157 \pm 0.004$ )	
12mm	See Note 1	8.2 (0.323)	1.5 (0.059)	$5.5 \pm 0.05$ ( $0.217 \pm 0.002$ )	6.5 Max. (0.256)	$4.0 \pm 0.10$ ( $0.157 \pm 0.004$ )	$12.0 \pm 0.30$ ( $0.472 \pm 0.012$ )
12mm Double Pitch						$8.0 \pm 0.10$ ( $0.315 \pm 0.004$ )	

ELD/B\_103.at3

Notes: 1. A0, B0 and K0 are determined by the maximum dimensions to the ends of the terminals extending from the component body and / or the body dimensions of the component. The clearance between the ends of the terminals or body of the component to the sides and depth of the cavity (A0, B0 and K0) must be within 0.05mm (0.002) minimum and 0.50mm (0.020) maximum. The clearance allowed must also prevent rotation of the component within the cavity of not more than 20 degrees (see Component Rotation).

2. Tape with components shall pass around radius.

3. The embossment hole location shall be measured from the spocket hole controlling the location of the embossment. Dimensions of embossment location and hole location shall be applied independent of each other.

4. B1 dimension is a reference dimension for tape feeder clearance only.

5. Electronic Industries Association, Standard EIA-481-1.

## Tape Layout

### Component Rotation

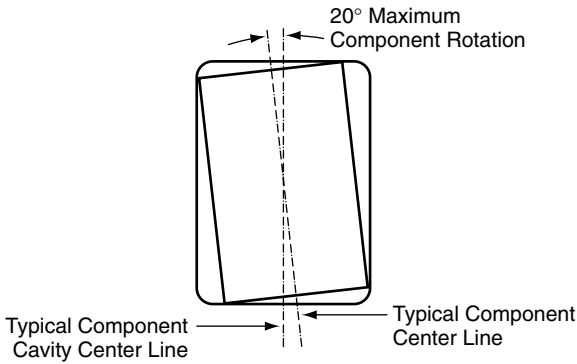

### Bending Radius

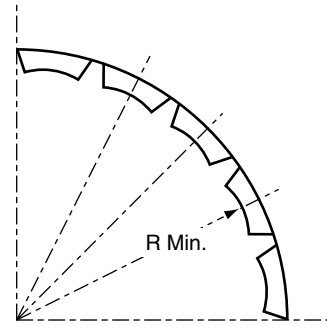

Emboss04.eps

### Tape Camber (Top View)

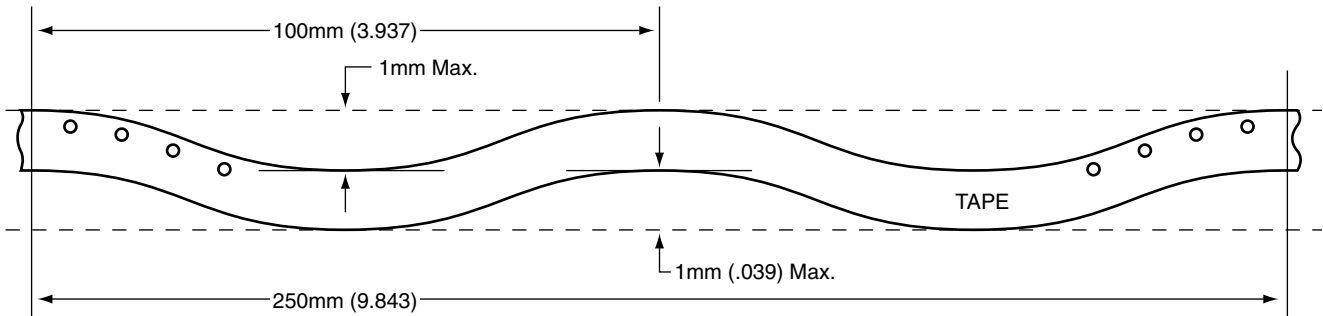

Allowable camber to be 1mm/100mm nonaccumulative over 250mm.

Emboss05.eps

### Tape Leader and Trailer Dimensions

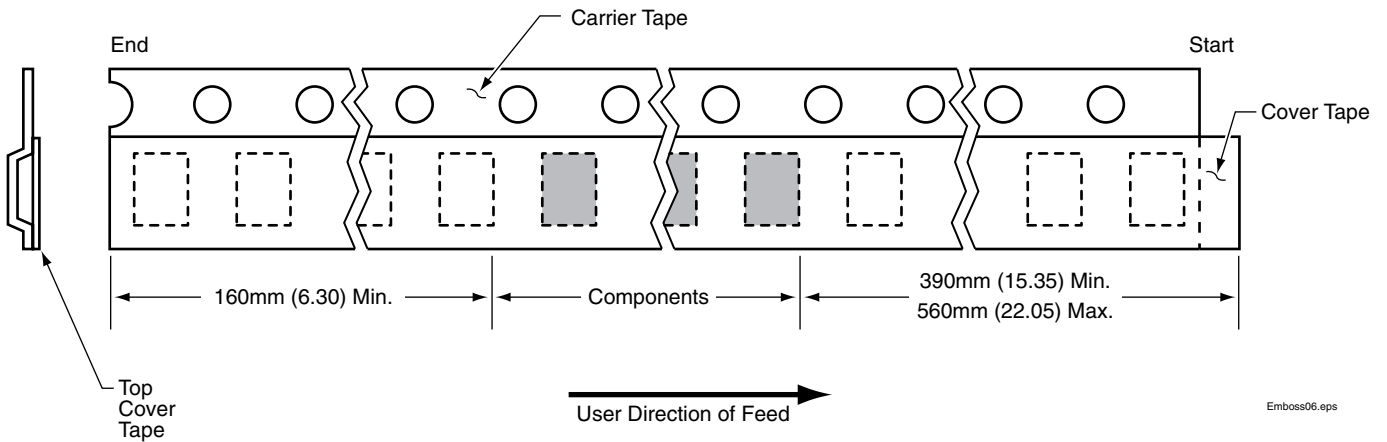

Emboss06.eps

## Reel Dimension

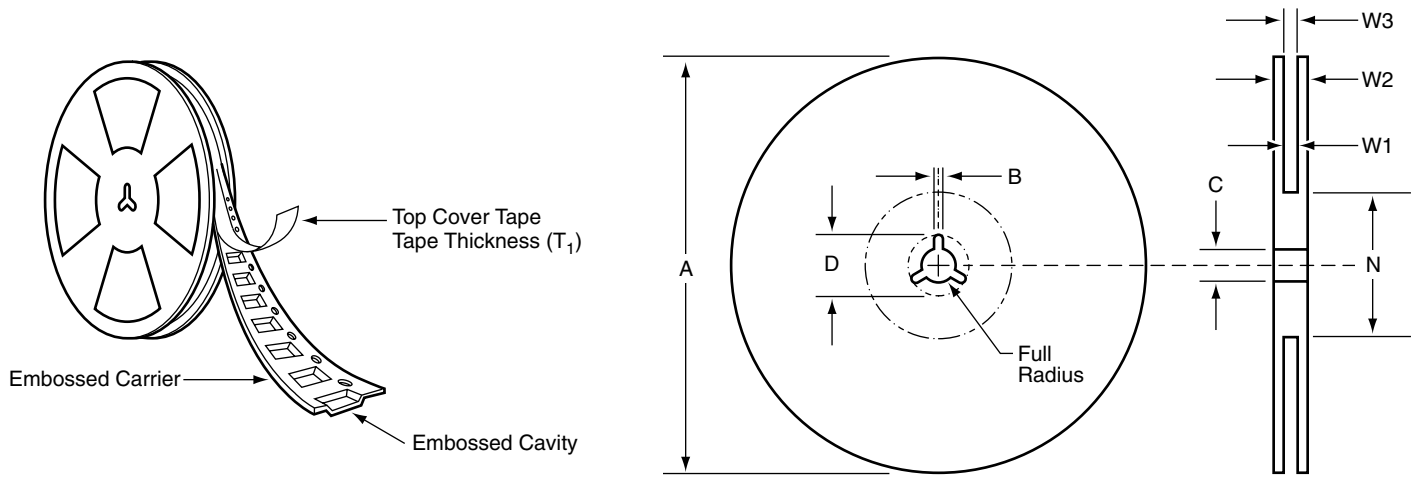

Emboss03.eps

Tape Size	A Max.	B Min.	C	D Min.	N Min.	W1	W2 Max.	W3
8mm	330 (12.992)	1.5 (0.059)	13.0 ± 0.20 (0.512 ± 0.008)	20.2 (0.795)	50 (1.969)	8.4 + 1.5 - 0.0 (0.331 + 0.059 - 0.0)	14.4 (0.567)	7.9 Min. (0.311) 10.9 Max. (0.429)
12mm						12.4 + 2.0 - 0.0 (0.488 + 0.078 - 0.0)	18.4 (0.724)	11.9 Min. (0.469) 15.4 Max. (0.607)

ELD/B\_101.eps

## Tape Layout

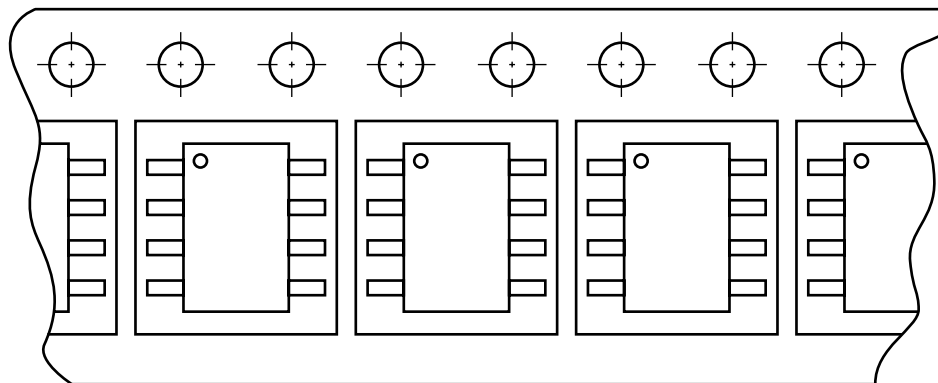
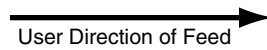

Emboss02.eps